

Phase Two:

1. Northern entrance ramp at Cars Rental is closed.
2. Avis, Budget, Hertz, Thrifty and Dollar clients use the Yellow Lot entrance to enter the parkade. They will be directed to their usual Car Returns spot as shown in this drawing.
3. National, Alamo and Enterprise are not affected at this phase and they will operate normally through southern ramp.

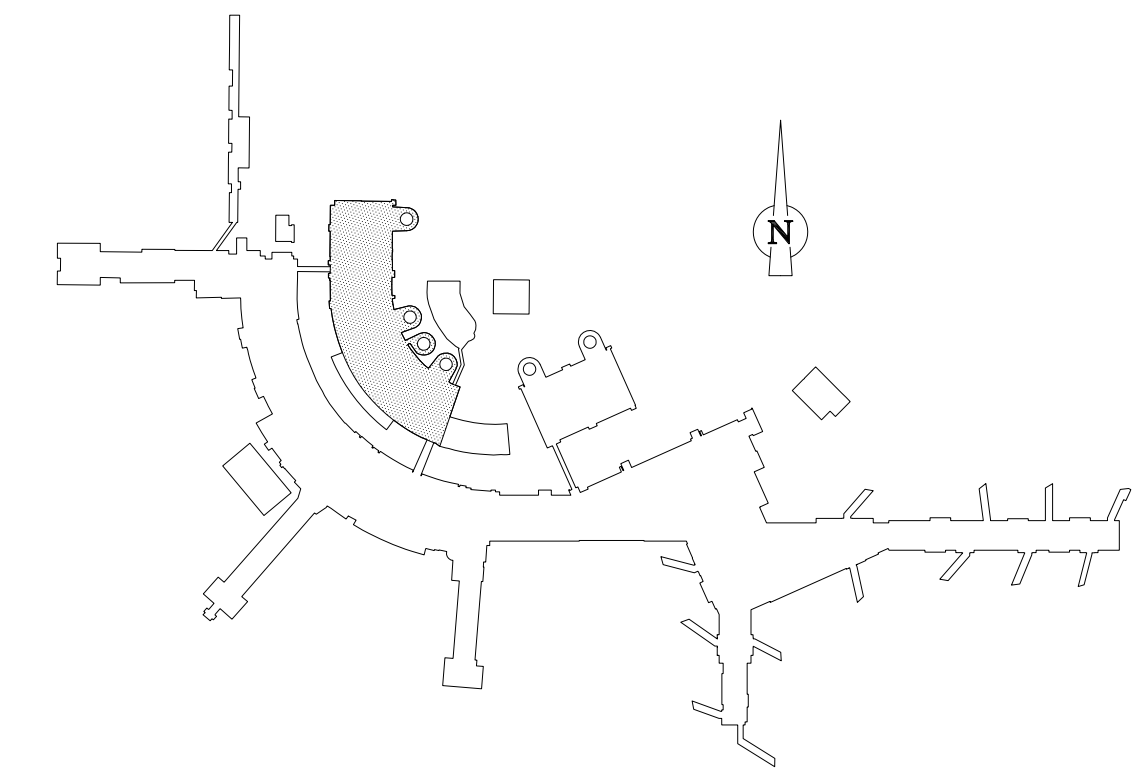
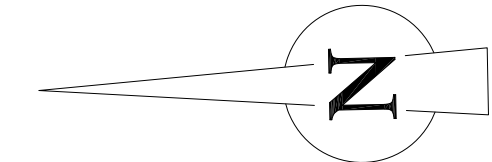
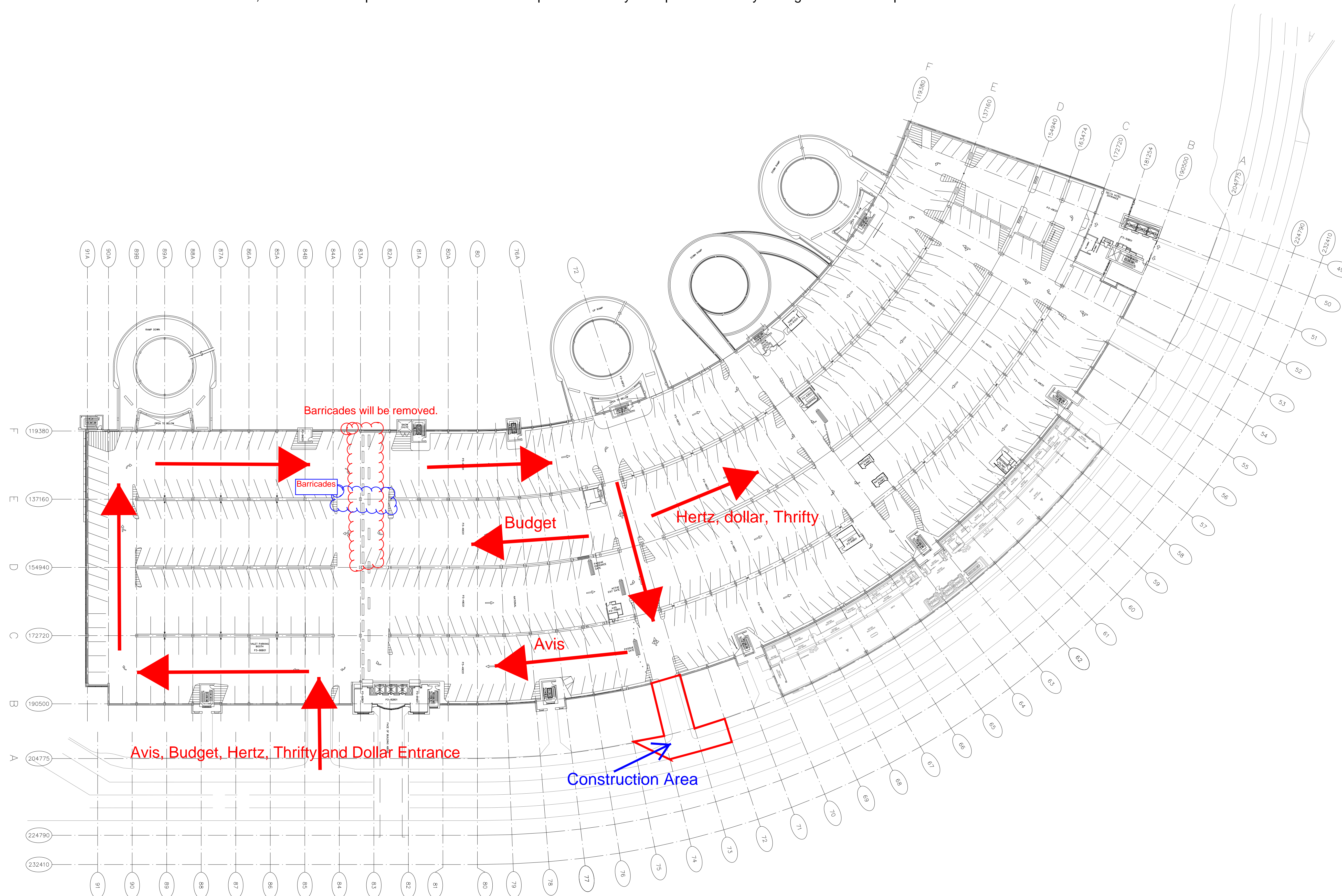

KEY PLAN

Airport terminal grid is radial, and is centered at Monument #702113.
 Local airport co-ordinates are Northing 18 415.2709 and Easting 16 173.6970.
 This information was compiled from various construction as-built drawings.
 Users of this information should verify any/all critical information, systems and dimensions.

Scale:	
Title:	CALGARY INTERNATIONAL AIRPORT
	PARKADE 1 - W145
	LEVEL 3
	BASE PLAN
Issue Date:	2016.12.29
	0 2 3 0 0 1 a a
	4 of 8